

[Home](#) ■ [Обладнання](#) ■ [Обладнання для зливної каналізації](#) ■ [Мех. очищення в дощоприймачах](#) ■  
[HUBER Горизонтальна решітка для переливів ROTAMAT® RoK1](#)

## HUBER Горизонтальна решітка для переливів ROTAMAT® RoK1



### Automatically cleaned screen for solids retention in stormwater tanks and overflows

- Efficient solids separation
- Continuous automatic screen cleaning
- Defined solids removal
- For discharges with limited upstream head possibilities
- Sturdy, low-maintenance stainless steel design

During and after storm events large amounts of debris are discharged to streams, rivers and lakes through storm water overflows of combined and sanitary sewer systems. Particularly endangered receiving water courses and nature preservation areas require more extensive measures concerning the treatment of stormwater.

The ROTAMAT® RoK 1 screen is the ideal solution for this task, whether for new structures or refurbishment. The screen belongs to a group of fine screens designed for high flow rates at an extremely low hydraulic resistance. Two-dimensional screening guarantees a very high solids retention combined with automatic, gentle cleaning of the perforated plate.

RoK 1 screens are horizontally installed directly behind the downstream side of overflow weirs. A screw flight is mounted on a half cylinder of perforated plate. As the stormwater flows through the horizontal perforated half-pipe of the screen trough the solids are retained. A screw, with a brush attached on its flights, rotates within the semi-circular screen trough. It cleans the screen and pushes

the screenings gently towards the end of the trough. At the end of the trough, the screenings are returned into the sewer and carried to the wastewater treatment plant. Alternatively, the screenings are removed from the plant with a pump for further disposal. During storm conditions the screen is automatically started and then works fully automatically.

## преимущества

The screen is installed behind the weir overflow. This design results in the following favourable benefits:

- Optimal solids retention by means of twodimensional screening (perforated plate)
- Low hydraulic resistance due to installation behind the overflow at weir height
- The perfect solution for discharges with limited upstream head possibilities
- Defined screenings discharge
- Problem-free retrofitting into existing structures
- Possibility of completely submerging the screen

## PDF скачать

 [проспект: HUBER ROTAMAT® Storm Screen for stormwater discharges RoK 1 \(по-английски\)](#) [pdf, 306 KB]

## примеры из практики

- [Storm Screening Case Study at Crankley Point STW](#)
- [Optimised stormwater overflow tank functions at Kappern/Austria](#)

## схема

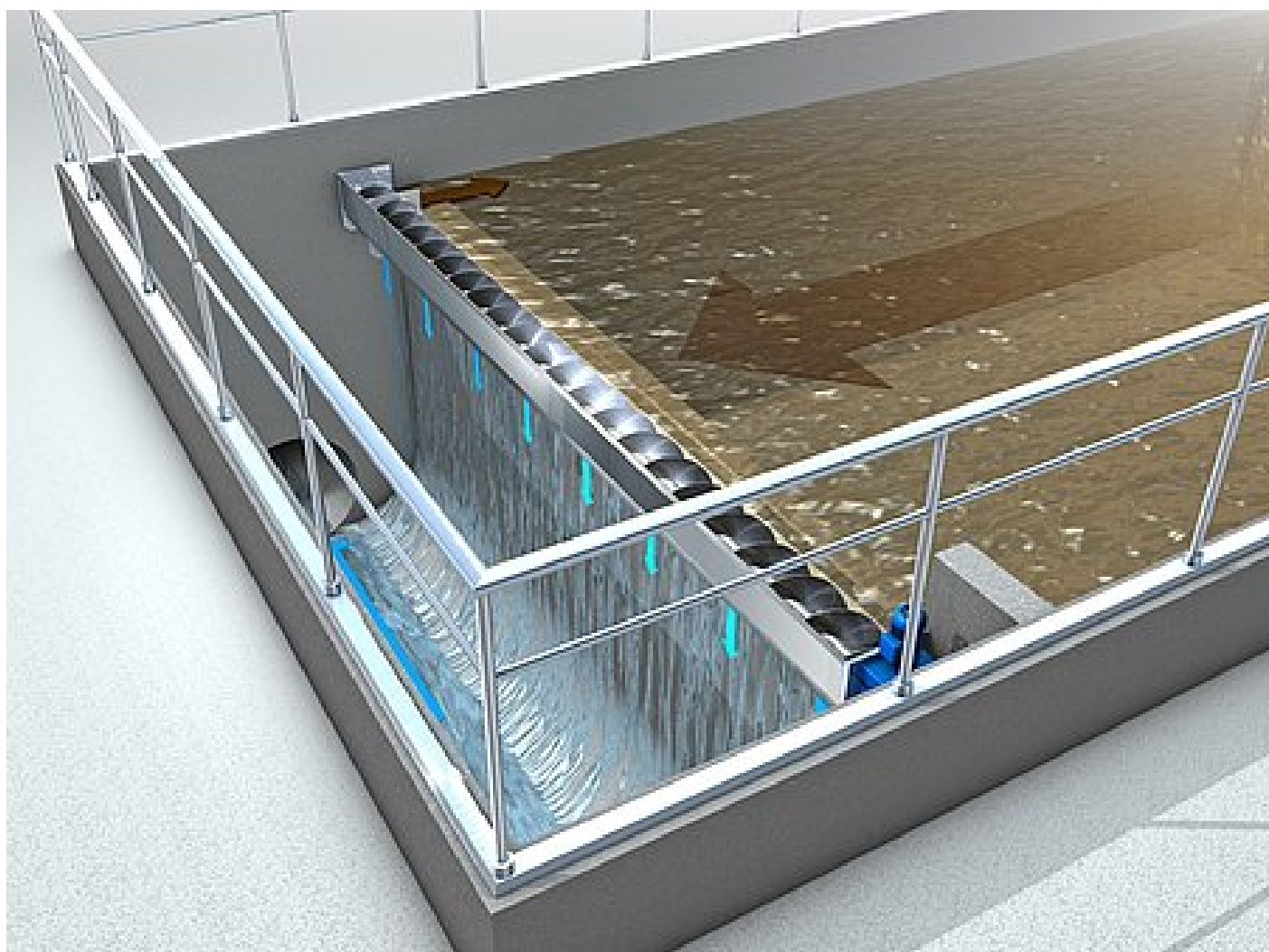

## фотографии



## Інше обладнання серії Мех. очищення в дощоприймачах

- [HUBER Горизонтальна решітка для переливів ROTAMAT® RoK2](#)

Biuro Handlowe: ul. Ryzowa 51, 02-495 Warszawa, tel. + 48 22 572-28-60; fax + 48 22 572 28 68  
Serwis: ul. Ryzowa 51, 02-495 Warszawa, tel. + 48 22 572-28-60; fax + 48 22 572 28 98  
KRS: 0000132940 Organ rejestrowy: Sąd Rej. dla m.st. W-wy w Warszawie, XIII Wydział Gospod. KRS

NIP 521-009-28-15  
KRS 0000132940  
Kapitał zakładowy 500.000 zł

Member of the HUBER group:  
[www.huber.de](http://www.huber.de)